

PCM

£2,400 PCM

Haberdasher Street

London, N1 6EH

Spacious two double bedroom apartment set within a period mansion block on a tree lined residential street in Old Street.

The property features a modern open-planned kitchen to reception room leading out onto a rear shared courtyard with space for table and chairs, family bathroom and two large double bedrooms with ample storage.

Old Street and Hoxton Stations are both close by as well an array of restaurants, bars and boutiques of Hoxton Square, Hoxton Street and Shoreditch just a moments walk.

Available start of June

Council Tax: Band C
5 Weeks Deposit: £2769





Haberdasher Street, N1 6EH

Approx. Gross Internal Area = 58.3 sq m / 627 sq ft

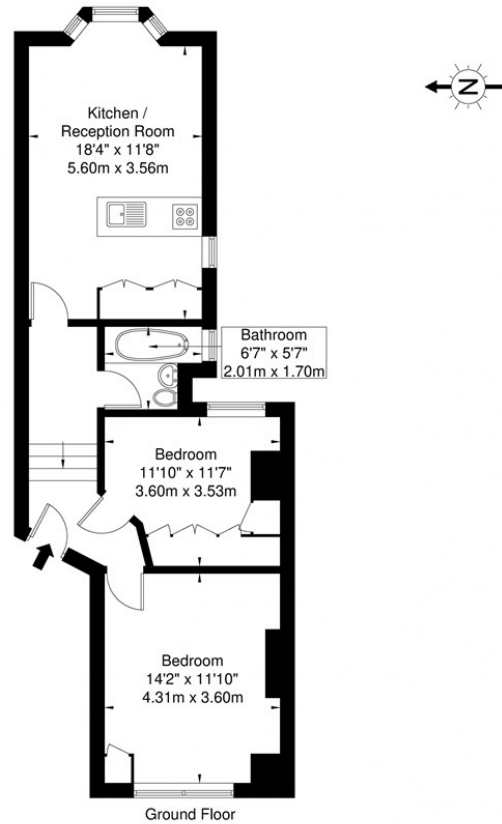

Ref

Copyright

**BLEU
PLAN**

Disclaimer : Floor plan measurements are approximate and are for illustrative purposes only. While we do not doubt the floor plan accuracy and completeness, you or your advisors should conduct a careful, independent investigation of the property in respect of monetary valuation.

Energy Efficiency Rating		Current	Potential
<i>Very energy efficient - lower running costs</i>			
(92 plus) A			
(81-91) B			
(69-80) C			72
(55-68) D	56		
(39-54) E			
(21-38) F			
(1-20) G			
<i>Not energy efficient - higher running costs</i>			
England & Wales		EU Directive 2002/91/EC	

Agents Note: Whilst every care has been taken to prepare these particulars, they are for guidance purposes only. All measurements are approximate and are for general guidance purposes only and whilst every care has been taken to ensure their accuracy, they should not be relied upon and potential buyers/tenants are advised to recheck the measurements

OFFICE ADDRESS

88 Cheshire Street
London
E2 6EH

OFFICE DETAILS

0207 739 6969
info@peachproperties.com
www.peachproperties.com